



## Academy # 1

### Grows-A-Lot: Urban Garden Site Plans + SAPS

#### Welcome (ACFB)

Introductions

(2:30-2:50 PM)

Team introduce themselves + Site  
Support Team

#### Power Point – today's theme

(2:50-3:00 PM)

Site Plans + SAPS

#### Garden Team Workstations

Rotate (3:00 – 3:30/ 3:30-4:00 PM)

SAP/Site Plan

#### Team Site Plan Presentations

(4:00-4:20 PM)

#### Next Steps/Homework

**Feb 2 Deadline:** turn in :SAP/Site Plan/Licensure/Fees/ Insurance

**Urban Garden Budget:** CoA - Teams

**Stake Phase 1**

# AGLANTA Introductions (2:30 – 2:50 PM)

## AgLanta Grows-A-Lot Team:

- ACFB, OoR, GWA, (UGA etc..)
- AgLanta Grows-A-Lot Advisory Committee members
- AgLanta's larger urban ag [community partners & resources](#)

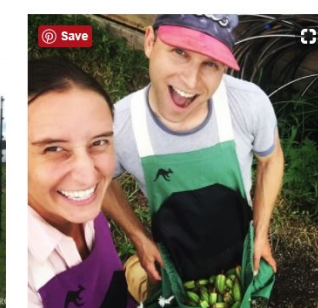
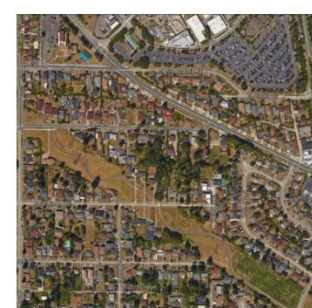
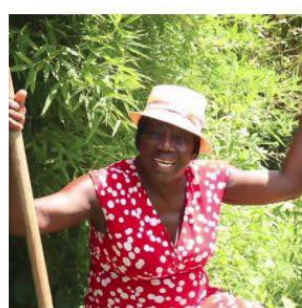

AgLanta Grows-A-Lot Pilot Urban Garden Teams:

- 1) Team members
- 2) Your garden site (current state + site plan ideas from pre-academy site visit/meetings)

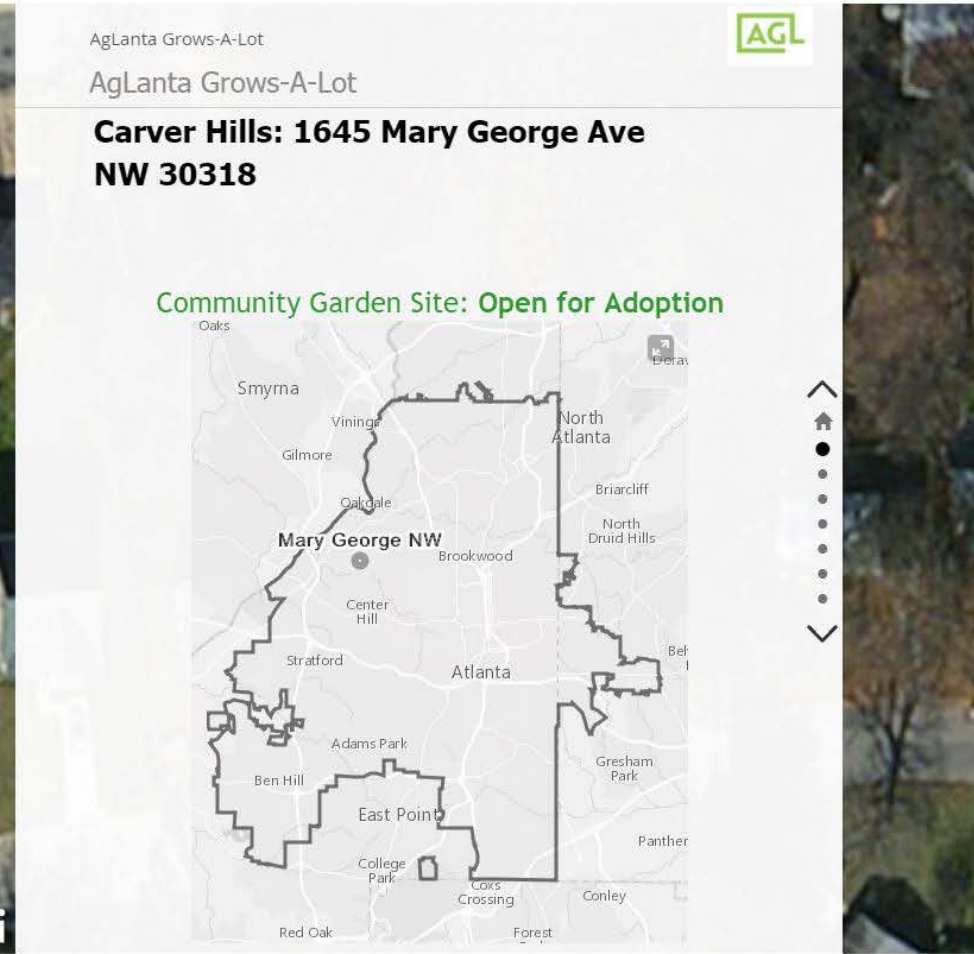
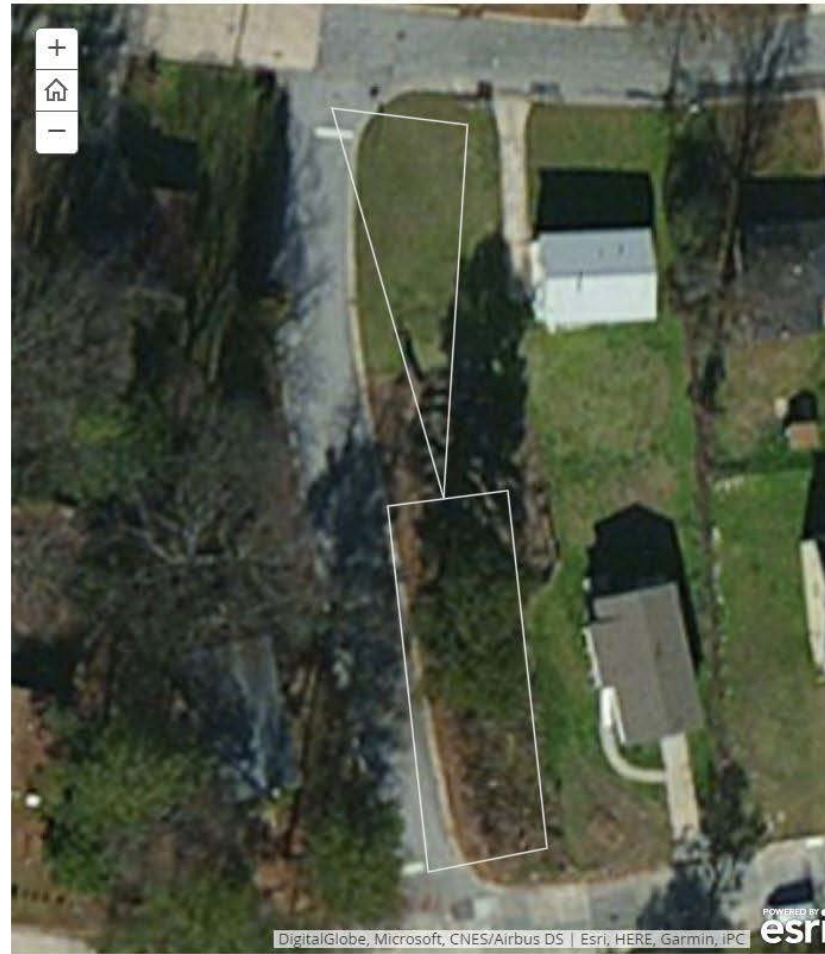
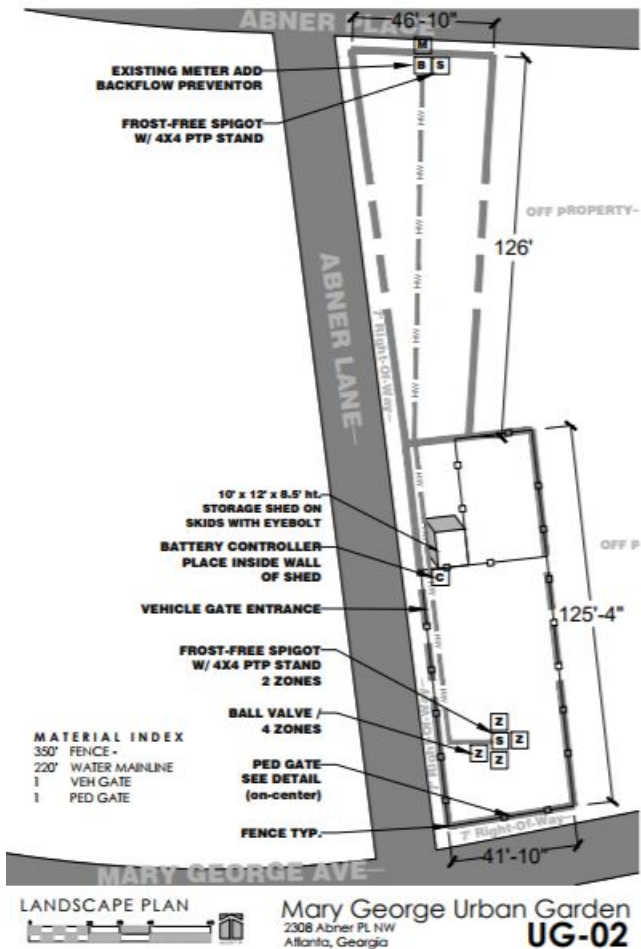

## AgLanta Grows-A-Lot Pilot Urban Garden Teams:

- 1) Team members
- 2) Your garden site (current state, pre-academy site visit/meeting ideas, etc.)

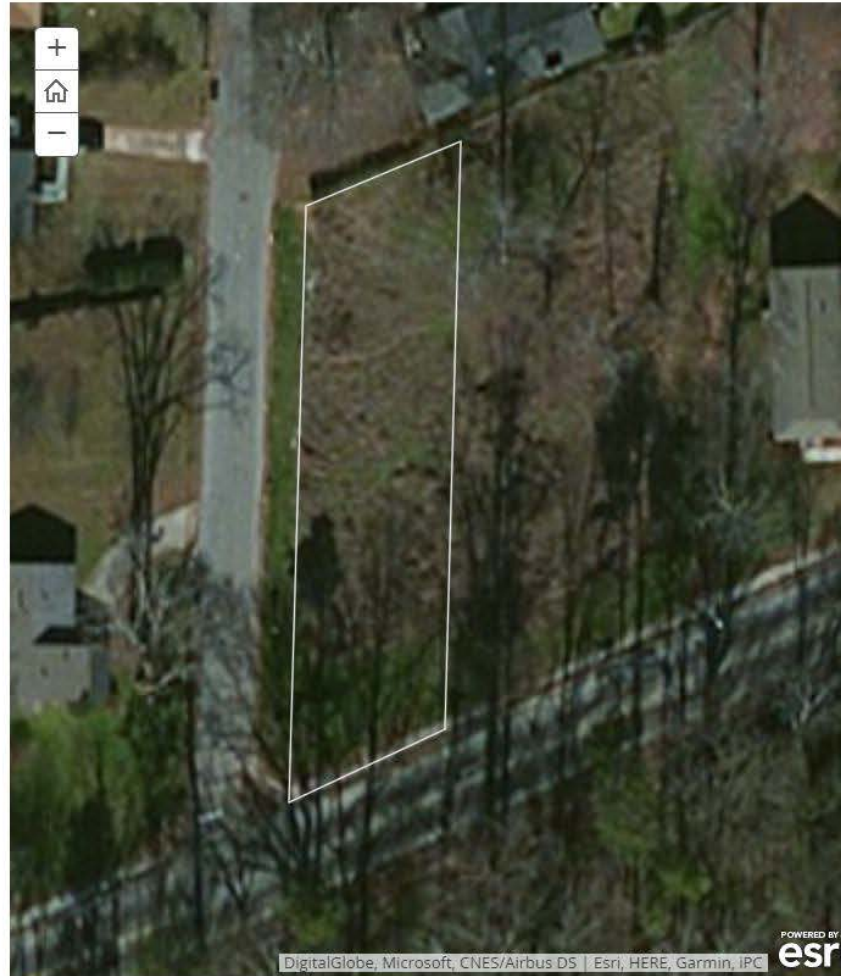
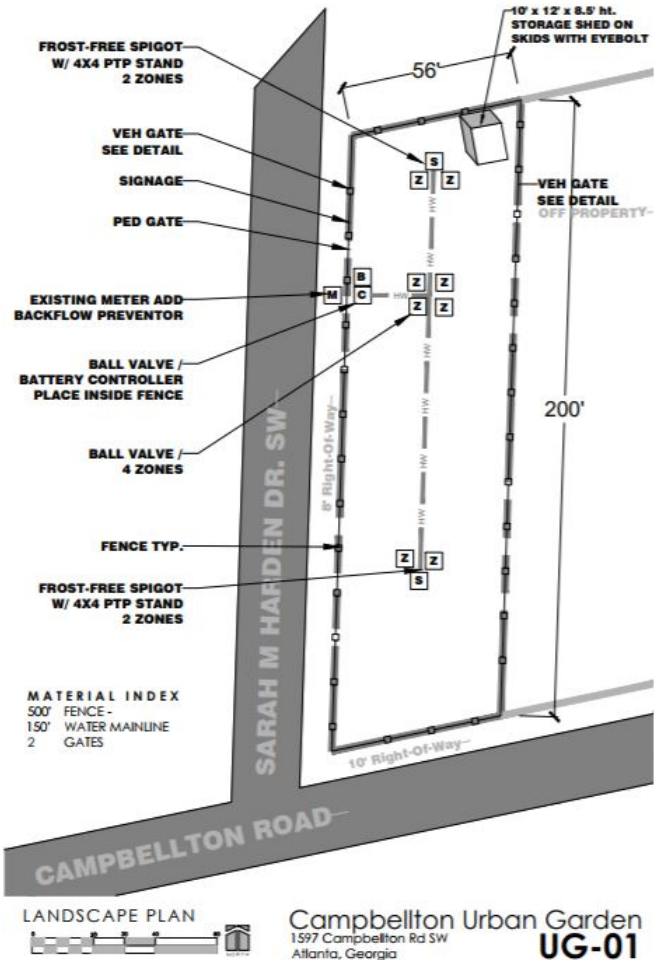

AgLanta Grows-A-Lot



AgLanta Grows-A-Lot

**Venetian Hills: 1597 Campbellton Rd. SW,  
30311**

Community Garden Site: Open for Adoption

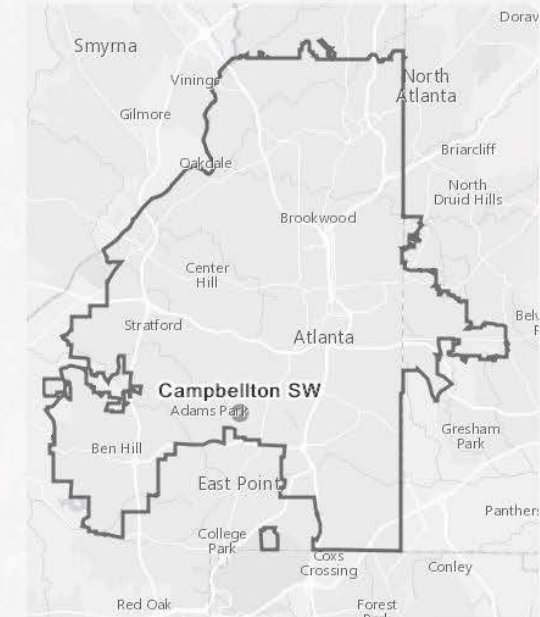

# AGLANTA Academy # 1: Urban Garden Site Plans + SAPS (Special Admin. Permits.)

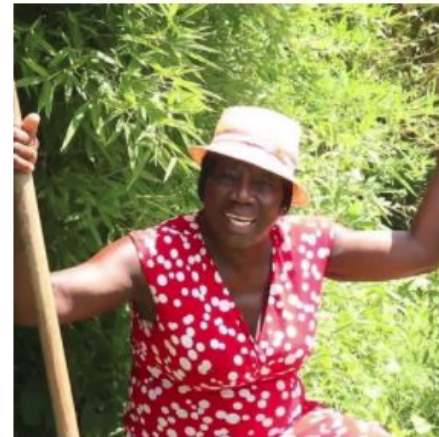



# AGLANTA Urban Garden Site Plans (2:50 – 3:00 PM)

Today we are going to discuss some **things to consider as you create your site plan:**

- **Your magic/ unique** site + team/partners/community's desires. (MG – Dip, MARTA, y
- Common community garden **models.**
- Common community garden **design elements.**
- **Tips** (safety: soil, beds, neighbors etc.)

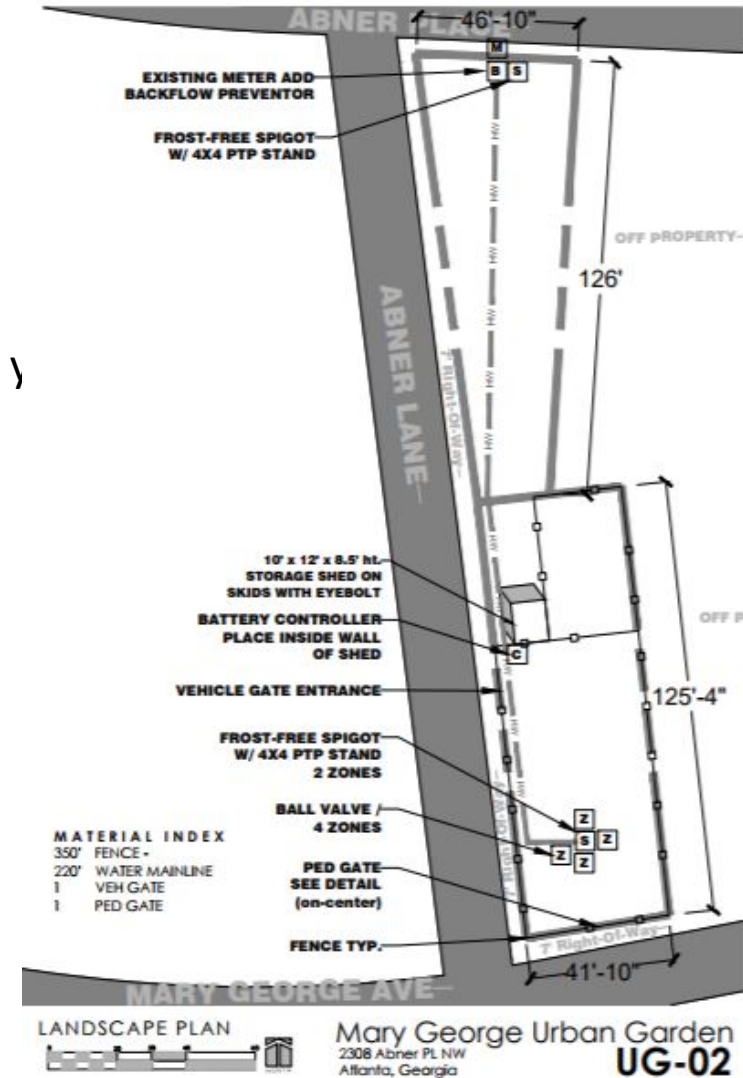

# AGLANTA Community Garden Models (2:50 – 3:00 PM)

Traditional community garden: comprised of separate plots cared for by individuals or families



However, within this model, there may be some shared areas for: fruit, herb beds, bike parking and repair etc.

\*Plant a row, "street food" beds etc.



# AGLANTA Community Garden Models (2:50 – 3:00 PM)

**Communal:** entire garden is planted, maintained, harvested by the group.



\*STAR beds – personal growth

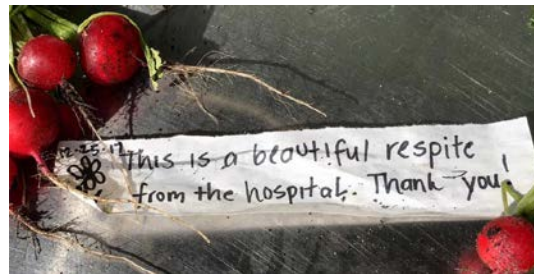

Specialty gardens: food forest gardens, entrepreneurship gardens, school gardens, elder gardens, Alzheimer gardens.

**COMMON GARDEN ELEMENTS**



**COMMON GARDEN ELEMENTS**



**FENCE ENTRY**



**FENCE**



**TOOL SHED**



**SEASON EXTENSION**



**SIGNAGE**



**EATING**



**ART**



**FRUIT**



**COMPOST**



**EXTENSION**



**PILES**



**ART**

Urban Agriculture: soil safety

Raised beds/soil safety:

- liner – (landscape fabric, cardboard, newspaper)
- free mulch- wood chips, sticks/brush
- compost
- fresh soil

Pathways:

- liner
- mulched

\*wash hands, gloves, wash produce

Groundwork Atlanta + Maurice  
Food well Alliance + Soil Fest  
[www.Aglanta.org](http://www.Aglanta.org)

Urban Agriculture: tips

Raised bed safety:

- Width: child able to reach to center safely (4')
- Height: 16" (maybe shorter or taller for elders)
- Materials: (cedar, treated, natural stains, no wood, natural wood, containers, vertical)
- Hoops: season extension, trellis, pests

Pathways safety:

- 3'-4' (wheelbarrow between wood raised beds)
- 1.5' -2' in-ground production
- mulch

Shady rest spot: under a tree, shelter

Communication spot: protected bulletin board/chalk board, plastic bin with folder, online, signs (water me /harvest me/mentor me etc.)

Neighborhood peace: flower borders, clean up, noise, odors, piles, drop off tomatoes, invite to events. Partners are everywhere. Allies protect.

**Goal:** Complete site plan + SAP (January)

**Station 1:** (3:00-3:30 PM)

**Urban Garden SAPS ( + )**

Blog/ Interviews: Maurice

**Station 2:** (3:30-4:00 PM)

**Site Plan**

\*Rotate!

**Present:** (4:00 – 4:20 PM)



# AGLANTA Garden budget template



**WHOLE FOODS MARKET** 5% OF OUR SALES ON TUESDAY, MARCH 29 WILL GO TO ROMNEY URBAN GARDEN

**ROMNEY URBAN GARDEN**

923 HOUSTON NORTHCUTT BLVD • MT PLEASANT • SC • 843.971.7240



Income	2017 Budget	Potential Aglanta/My Community Resource
Foundation/Grant	\$ -	
Garden Plot Rentals/Membership Fees	\$ -	
Event Rentals	\$ -	
Classes/Field Trips	\$ -	
Fundraiser	\$ -	
Plant Sale	\$ -	
<b>Total Income</b>	<b>\$ -</b>	
<b>Expenses (Professional)</b>		
Design Assistance for SAP Site Plan	\$ -	Free LA - OoR Workshop
Construction		Volunteer Neighbor
Garden Manager		Volunteer Neighbor
Soil Testing - nutrients		FWA Website
<b>Expences Start-Up</b>		
Raised Beds/(\$260 bed)		
Compost (10 yds)		SEE AFA Resource List
Soil		SEE AFA Resource List
Mulch-Wood Chips	\$ -	Free Tree Company Donations
Delivery		Neighbor with a Truck? OoR?
Garden fence		
Stakes		
String		
Tool Bank Membership	\$ 15.00	Garden Sponsor Organization
Compost Bin Supplies	\$ 280.00	
Signage	\$ 300.00	
Picnic Table - Bench	\$ 100.00	
Water meter + Backflow (2.5 K)		OoR
Tools - Onsite	\$ 350.00	
Trash Bin		
<b>Total Start up</b>	<b>\$1,045.00</b>	
<b>Expences - Extra's and Annual Maintenance</b>		
Land Rental - Annual License Fee	\$ 1.00	Reduced -OoR
Land Rental- Annual Administrative Fee	\$ -	Waived for Pilot Partners
Insurance	\$ -	Reduced -GWA
Stipend Garden Manager/Coordinator	\$ -	
Monthly Water Bill (Reduced Rate)	\$ -	
Tool Shed	\$0.00	
Shade Structure	\$ -	
Greenhouse	\$ -	
City of Atlanta Urban Garden SAP	\$ 30.00	
Compost		SEE AFA Resource List
Seeds/Starts		SEE AFA Resource List
PR/Printing		
Event Supplies		
<b>Sub Total Expense</b>		
Indirect Costs @ 10%	\$ -	
<b>Total Expense</b>	<b>\$ -</b>	
<b>Balance</b>	<b>\$ -</b>	



## Academy # 1

### Grows-A-Lot: Urban Garden Site Plans + SAPS

#### Welcome (ACFB)

Introductions

(2:30-2:50 PM)

Team introduce themselves + Site  
Support Team

#### Power Point – today's theme

(2:50-3:00 PM)

Site Plans + SAPS

#### Garden Team Workstations

Rotate (3:00 – 3:30/ 3:30-4:00 PM)

SAP/Site Plan

#### Team Site Plan Presentations

(4:00-4:20 PM)

#### Next Steps/Homework

**Feb 2 Deadline:** turn in :SAP/Site Plan/Licensure/Fees/ Insurance

**Urban Garden Budget:** CoA - Teams

**Stake Phase 1**